



Public Document Pack

Melksham Town Council

Town Hall, Melksham, Wiltshire, SN12 6ES
Tel: (01225) 704187

Town Clerk and RFO Linda Roberts BA(Hons) PGCAP, FHEA,
FLSCC

To: Councillor J Hubbard (Chair)
Councillor G Cooke (Vice-Chair)
Councillor P Aves
Councillor S Crundell
Councillor G Ellis
Councillor C Goodhind
Councillor S Mortimer
Councillor J Oatley
Councillor S Rabey

15 February 2022

Dear Councillors

In accordance with the Local Government Act (LGA) 1972, Sch 12, paras 10 (2)(b) you are invited to attend the **Economic Development and Planning Committee** meeting of Melksham Town Council. The meeting will be held at **Melksham Town Hall in the Committee Room** on **Monday 21st February 2022** commencing at **7.00 pm**.

A period of public participation will take place in accordance with Standing Order 3(e) prior to the formal opening of the meeting. The Press and Public are welcome to attend this meeting.

Yours sincerely

Mrs L A Roberts BA(Hons), PGCAP, FHEA, FSLCC
Town Clerk and RFO

Melksham Town Council
Economic Development and Planning Committee

Public Participation – To receive questions from members of the public.

In the exercise of Council functions. Members are reminded that the Council has a general duty to consider Crime & Disorder, Health & Safety, Human Rights and the need to conserve biodiversity. The Council also has a duty to tackle discrimination, provide equality of opportunity for all and foster good relations in the course of developing policies and delivery services under the public sector Equality Duty and Equality 2010.

AGENDA

Virtual Meeting Access

Please follow the joining instructions below for the virtual Zoom meeting:

Join Zoom Meeting:

<https://us02web.zoom.us/j/85695738926?pwd=bGZ5cjltVT1Z0azFuY3p2UHV1WS82QT09>

Meeting ID: **856 9573 8926**

Passcode: **056148**

1. Apologies

To receive apologies for absence.

2. Declarations of Interest

To receive any Declarations of Interest in respect of items on this agenda as required by the Code of Conduct adopted by the Council.

Members are reminded that, in accordance with the Council's Code of Conduct, they are required to declare any disclosable pecuniary interest or other registrable interests which have not already been declared in the Council's Register of Interests. Members may however, also decide, in the interests of clarity and transparency, to declare at this point in the meeting, any such disclosable pecuniary interests which they have already declared on the Register, as well as any other registrable or other interests.

3. Minutes (Pages 1 - 6)

To approve the Minutes of the Economic Development and Planning Committee meeting held on 31 January 2022.

4. Planning Applications

Email: towncouncil@melksham-tc.gov.uk **Web:** www.melksham-tc.gov.uk
Facebook: facebook.com/melksham.town

To comment on the following planning applications:

[PL/2021/07899](#) 1 CHURCH LANE, MELKSHAM, SN12 7EE
Conservatory/Corridor Extension.
Consultation Deadline: 10/03/2022

5. Planning Decisions

To note the following planning decisions:

[PL/2021/11712](#) INGLEWOOD HOUSE, 4 PLACE ROAD, MELKSHAM, SN12 6JN
Row of Leylandii trees forming hedge – reduce height by one-third.
MTC Consultee Response: No Objection
Decision: No Objection

[PL/2021/03132](#) 43 TEACHERS WAY, MELKSHAM, SN12 8FA
Loft conversion with Velux roof lights
MTC Consultee Response: No Comment
Decision: Withdrawn by applicant

[PL/2021/09341](#) LIDL, BATH ROAD, MELKSHAM, SN12 8AB
Proposed extension to existing store along with internal and external refurbishment, re-arrangement of the car park, along with ancillary works.
MTC Consultee Response: No Objection
Decision: Approve with Conditions

[PL/2021/03172](#) 7 SANDRIDGE ROAD, MELKSHAM, SN12 7BE
Erection of a garden wall 1.5m high to front of property adjacent footpath.
MTC Consultee Response: No Comment
Decision: Withdrawn by Applicant

[PL/2021/10296](#) 14 CORFE ROAD, MELKSHAM, SN12 6BQ
Partial demolition of existing attached garage and erection of new extension to replace and extend over first floor of garage at rear. Partial removal of existing conservatory replaced with masonry construction. Construction of outbuilding to function as Home Office.
MTC Consultee Response: No Objection
Decision: Approve with Conditions

[PL/2021/10094](#) 24 TRENT CRESCENT, MELKSHAM, SN12 8BG
Proposed First Floor Side Extension
MTC Consultee Response: No Objection

Decision: Approve with Conditions

[PL/2021/07450](#)

LAND ADJACENT TO ELECTRICITY SUB STATION, WESTERN WAY (A350),

MELKSHAM, WILTSHIRE

Retrospective change of use of open countryside to a traveller site for up to three caravans with associated on-site car parking and the proposed construction of a day room

MTC Consultee Response: Object

Decision: Refuse

[PL/2021/10256](#)

2 QUEENSWAY, MELKSHAM, SN12 7JY

Application for the removal of no.1 unallocated lay-by parking space and creation of no.2 off street parking spaces and associated works including relocation of street furniture and turning head.

MTC Consultee Response: Object

Decision: Approve with Conditions

[PL/2021/07341](#)

3 NEW LAWNS, MELKSHAM, SN12 7UB

Retrospective) Removal of existing asphalt drive (draining into a freshwater drainage system created as part of the original construction of the property) and adjacent gravelled areas and replace with a new, printed concrete drive

MTC Consultee Response: No Objection

Decision: Approve with Conditions

[PL/2021/11578](#)

70 DUNCH LANE, MELKSHAM, SN12 8DX

Proposed Single Storey Rear Extension

MTC Consultee Response: No Objection

Decision: Approve with Conditions

[PL/2021/11635](#)

48 CHURCHILL AVENUE, MELKSHAM, SN12 7JE

Demolish pre cast concrete garage and rear shed/link to house and replace with new linked single storey extension.

MTC Consultee Response: No Objection

Decision: Approve with Conditions

[PL/2021/11738](#)

8 FULLERS CLOSE, MELKSHAM, SN12 7BX

Proposed Single Storey Side extension.

MTC Consultee Response: No Objection

Decision: Approve with Conditions

[PL/2021/09635](#)

LAND REAR OF 39 WOODROW ROAD, MELKSHAM, SN12 7AY

Erection of new dwelling.

MTC Consultee Response: No Objection

Decision: Refuse

6. Planning Appeal Notification 30 St Michael's Road, Melksham (Pages 7 - 8)

Members are requested to formulate a response to the appeal against the refusal of planning permission for 30 St Michael's Road, Melksham (see Planning Appeal Notification attached).

Planning Application

[PL/2021/06935](#)

30 St Michael's Road, Melksham SN12 6HN

Change of use of land to domestic curtilage with erection of fence.

MTC Response: OBJECT on the following grounds:

1. Loss of green space
2. On highways grounds: traffic approaching from the direction of the school will not be able to see vehicles leaving the property
3. On highways grounds: traffic approaching from the north-east (from the direction of the school) will not be able to see vehicles leaving the property
4. On highways grounds: traffic leaving the property safely will have to go to the end of this no through road to turn, in order to return and egress at Semington Road. This will result in a detrimental increase in traffic congestion on this residential street and in an area used as a walk through by school children.

7. Community Area Transport Group (CATG) Issues

Members will need to decide whether to support the requests and recommend to the Community Area Transport Group (CATG).

7.1 Community Area Transport Group (CATG) Budget and Committed Expenditure (Pages 9 - 12)

To note the attached the CATG budget and committed expenditure to date.

7.2 Highways Improvement Form - Eastern Way Melksham from Junction with Snowberry Lane to T junction with Camomile Place (Pages 13 - 14)

To consider the attached request submitted for the implementation of a 30 mph speed limit and a 3T MGW weight restriction.

7.3 Highways Improvement Request Form - Wharf Court Spa Road Melksham (Pages 15 - 16)

To consider the attached request submitted for the installation of signage to indicate a concealed entrance at Spa Road and Wharf Court.

- 7.4 **Highways Improvement Request Form - corner of Lapwing Road and Linnet Lane, Melksham** (Pages 17 - 18)
- To consider the attached request submitted for the installation of railings or metal bollards at the corner of Lapwing Road and Linnet Lane to increase pedestrian safety.
- 7.5 **High Ways Improvement Notice - audible alerts at three pedestrian crossings at the junction of Church Street and High Street, Melksham** (Pages 19 - 20)
- To consider the attached request submitted for the re-instatement of the audible alerts at the three pedestrian crossings at the junction of Church Street and High Street Melksham.
- 7.6 **Highways Improvement Request Form - vehicular access to Snarlton Farm, Melksham** (Pages 21 - 22)
- To consider the attached request submitted for the installation of signage on the A3102 to direct HGV Drivers to Snarlton Farm, Melksham.
- 7.7 **Sandridge Road - Maple Close**
- Members are asked to consider entering into negotiations with Wiltshire Council and the resident who has offered a section of his garden to enable the widening of the footway. The Town Clerk will give a verbal report.
- 7.8 **Correction to Traffic Survey Results - Spa Road Melksham** (Pages 23 - 24)
- To note the correction to the traffic survey results carried out by Wiltshire Council on Spa Road which indicate that no further action is required (see attached).
8. **Proposed Pedestrian Crossing - A350 Western Way Melksham** (Pages 25 - 32)
- To decide on a response to Wiltshire Council proposal for a pedestrian crossing for the A350 Western Way. (see attached Notice, Zebra Crossing legal advert, Staggered Toucan Crossing legal advert and ITM Statement of Reasons).
9. **Reinstatement of Electric Vehicle Charging Points, King Street Car Park Melksham** (Pages 33 - 36)
- To note the letter sent to Wiltshire Council from the Town Clerk and response from Councillor McClelland of Wiltshire Council regarding the reinstatement of electric vehicle charging points in King Street Car Park (see attached).
10. **Amended Pre-Consultation on Parking Restrictions for Melksham Campus** (Pages 37 - 40)

To consider a response to the Wiltshire Council proposed amendments to the parking restrictions for the Melksham Campus (see attached).

11. Sparkle Team and Parish Steward

To consider jobs to be undertaken by the Sparkle Team and Parish Steward.

This page is intentionally left blank

Melksham Town Council

Minutes of the Economic Development and Planning Committee meeting held on Monday 31st January 2022

PRESENT:

Councillor G Cooke (Vice-Chair)
Councillor P Aves
Councillor G Ellis
Councillor C Goodhind
Councillor S Mortimer
Councillor J Oatley
Councillor S Rabey

OFFICERS:

Patsy Clover	Acting Deputy Town Clerk
Jeff Mills	Communications Officer

PUBLIC PARTICIPATION: Two members of the public and one member of the press were present.

184/21 Apologies

Apologies were received from the Town Mayor, Councillor Hubbard, and Councillor S Crundell. Councillor Cooke chaired the meeting.

185/21 Declarations of Interest

There were no declarations of interest.

186/21 Minutes

It was proposed by the Chair, Councillor Cooke, seconded by Councillor Rabey and

UNANIMOUSLY RESOLVED that the minutes of 10 January 2022 having previously been circulated, were approved as a correct record and signed by the Chair, Councillor Cooke.

187/21 Useful Documents when responding to Planning Applications

It was agreed that members would need to take the Joint Melksham Neighbourhood Plan into consideration when deciding on all future planning applications.

188/21 Planning Applications

The Council had **no objection** to the following planning applications:

[PL/2021/11738](#)

8 FULLERS CLOSE MELKSHAM SN12 7BX

Proposed single storey side extension.

Consultation deadline: 28/01/2022 (Extension to consultation deadline requested)

It was proposed by Councillor Rabey, seconded by Councillor Aves and

UNANIMOUSLY RESOLVED to support the planning application

[PL/2021/11811](#)

5 SKYLARK ROAD MELKSHAM SN12 7FP

Single storey side extension and associated alterations.

Consultation deadline: 01/02/2022

It was proposed by Councillor Rabey, seconded by Councillor Aves and

UNANIMOUSLY RESOLVED to support the planning application

[PL/2021/09685](#)

39 DAISY CLOSE MELKSHAM SN12 6FZ

Single storey side extension to provide disabled facilities.

Consultation deadline: 03/02/2022

It was proposed by Councillor Rabey, seconded by Councillor Aves and

UNANIMOUSLY RESOLVED to support the planning application

[PL/2022/00130](#)

4 ROUNDPOND MELKSHAM SN12 8DH

Proposed single storey extensions.

Consultation deadline: 07/02/2022

It was proposed by Councillor Rabey, seconded by Councillor Aves and

UNANIMOUSLY RESOLVED to support the planning application

[PL/2021/11896](#)

LONGHOPE GUEST HOUSE 9 BEANACRE ROAD SN12 8AG

Removal/variation of conditions

Variation of conditions, 2, 5, & 6 on 19/07763/FUL to allow for minor changes to internal layout to create 6x 1-bedroom flats instead of 6x 2-bed flats

MTC Response to 19/07763/FUL – No Objections

Consultation deadline: 07/02/2022

It was proposed by Councillor Rabey, seconded by Councillor Ellis and

UNANIMOUSLY RESOLVED to support the planning application subject to the following proposed conditions in line with policies contained in the Joint Melksham Neighbourhood Plan.

- *Policy 4 – Ultra Low Emission Vehicle Charging* -the developer to be encouraged to provide electric vehicle charging points.
- *Policy 2 – Local Renewable and Low Carbon Energy Generation* - the developer to be encouraged to install solar panels.
- *Policy 14 – Open Spaces* – the developer to be encouraged to provide a planting scheme in the shared open space to contribute to community well-being.

[PL/2022/00125](#)

KING STREET MELKSHAM SN12 6HE

Proposed 3 No. new terraced dwellings.

Consultation deadline: 08/02/2022

It was proposed by Councillor Aves, seconded by Councillor Ellis and

UNANIMOUSLY RESOLVED to support the planning application subject to the following proposed conditions in line with policies contained in the Joint Melksham Neighbourhood Plan.

- *Policy 4 – Ultra Low Emission Vehicle Charging* -the developer to be encouraged to provide electric vehicle charging points.
- *Policy 2 – Local Renewable and Low Carbon Energy Generation* - the developer to be encouraged to install solar panels.

[PL/2022/00453](#)

8 KENILWORTH GARDENS MELKSHAM SN12 6AE

Single storey rear extension to enlarge the kitchen

Consultation deadline: 17/02/2022

It was proposed by Councillor Aves, seconded by Councillor Ellis and

UNANIMOUSLY RESOLVED to support the planning application.

[PL/2022/00270](#)

Works to a Listed Building

SHURNHOLD FARMHOUSE SHURNHOLD MELKSHAM SN12 8DF

Conversion of outbuildings to use as holiday let and air bnb.

Consultation deadline: 18/02/2022

It was proposed by Councillor Rabey, seconded by Councillor Oatley and

UNANIMOUSLY RESOLVED to support the planning application for works to a listed building.

[PL/2021/11763](#)

SHURNHOLD FARMHOUSE SHURNHOLD MELKSHAM SN12 8DF

Conversion of outbuildings to use as holiday let and Airbnb.

Consultation deadline: 18/02/2022

It was proposed by Councillor Rabey, seconded by Councillor Oatley and

UNANIMOUSLY RESOLVED to support the planning application subject to the following proposed conditions in line with policies contained in the Joint Melksham Neighbourhood Plan.

- *Policy 4 – Ultra Low Emission Vehicle Charging* -the developer to be encouraged to provide electric vehicle charging points.
- *Policy 2 – Local Renewable and Low Carbon Energy Generation* - the developer to be encouraged to install solar panels and ground source heat pumps.

189/21 Planning Decisions

Members noted the following planning decision:

[PL/2021/11742](#)

56 SPA ROAD MELKSHAM SN12 7NY

Lawful Development Certificate for Proposed Use
Single storey rear extension.

MTC Consultee Response: No response required

Decision: Approve with Conditions

190/21 Community Area Transport Group (CATG) Issues

190/21.1 Waiting Restriction request for highway adjacent to 92-101 Bath Road Melksham

After some discussion it was proposed by Councillor Cooke, seconded by Councillor Aves and

UNANIMOUSLY RESOLVED to recommend to the Community Area Transport Group (CATG), the introduction of resident's parking permits and the implementation of a two hours parking restriction scheme for non-residents, based on the scheme previously in existence, adjacent to the Almshouses at 92-101 Bath Road, Melksham.

190/21.2 Highways Improvement Notice for the end of The Crays towards Montague Place, Melksham

It was proposed by Councillor Aves, seconded by Councillor Oatley and

UNANIMOUSLY RESOLVED to recommend to the Community Area

Transport Group (CATG), the implementation of dropped kerbs either side of the pavement at the end of The Crays towards Montague Place.

191/21 Traffic Surveys Results

191/21.1 Traffic Surveys Results - No Further Action

The results of traffic surveys carried out by Wiltshire Council on the following roads were noted.

- Church Lane Melksham
- Forest Road Melksham
- Lowbourne (South of Ruskin Avenue) Melksham
- Queensway Melksham
- Skylark Road Melksham
- Spa Road Melksham

191/21.2 Traffic Surveys Results - Qualify for Community Speed Watch

The results of the traffic surveys carried out by Wiltshire Council on Coronation Road and Pembroke Road were noted.

The Deputy Town Mayor, Councillor Goodhind, explained that there were very effective Community Speedwatch groups operating in Melksham but that these groups needed to be monitored and supported. He suggested the CCTV/Community Safety Group be involved in the traffic survey process.

It was proposed by the Deputy Town Mayor, Councillor Goodhind, seconded by Councillor Oatley and

UNANIMOUSLY RESOLVED to ask residents of Coronation and Pembroke Road whether they would be willing to set up a Speed Watch Group.

192/21 Melksham Campus Pre-Consultation on Parking Restrictions

It was agreed that the Acting Deputy Town Clerk would write to Wiltshire Council with the following comments:

- the ability to park should primarily be linked to use of the Campus.
- it was noted that the number of parking spaces is limited – will the Campus be accessible by public transport- the Town Bus, a bus link from the railway station?
- the Council requested that virtual/electronic/ANPR methods of payment for parking should be investigated.

- the Council were concerned about the adequacy of the proposed power capacity for the EV charging points.
- the Council welcomed that Campus staff would be able to arrange for extended stays for visitors beyond the three hours parking limit.
- the Council were concerned about the management of permits enabling on-site clubs and tenants to park beyond the three-hour limit. It was felt that this should be linked to use of the Campus.
- would the number of permits issued to each on-site club/tenant be restricted? and would the period of time covered by the permits be restricted?

193/21 Sparkle Team and Parish Steward

Members asked for the following jobs to be forwarded for action by the Sparkle Team/Parish Steward:

- Pavement off Lowbourne linking with the car park – rotting leaves to be removed.
- Bus Shelters at Shurnhold, George Ward and Roundpond – leaves to be cleared.
- Various areas around Melksham Town - fly-posters to be removed from communication boxes.

194/21 Environment Agency -Northacre Renewable Energy Ltd Addendum to Schedule 5 Notice - Westbury Incinerator

The Environment Agency Briefing 13 was noted.

Meeting Closed at: 8.36 pm

Signed:

Dated:

15 February 2022

Development Services
Wiltshire Council
Tel: 0300 456 0114
www.wiltshire.gov.uk
PlanningAppeals@wiltshire.gov.uk

Our Ref: PL/2021/06935

Dear Sir/Madam,

TOWN AND COUNTRY PLANNING ACT 1990

APPELLANTS NAME:	Mrs Natasha Nicholas
APPEAL SITE:	30 St Michael's Road, Melksham, SN12 6HN
PROPOSED DEVELOPMENT:	Change of use of land to domestic curtilage with erection of fence.
INSPECTORATE REFERENCE:	APP/Y3940/W/21/3288445
APPEAL START DATE:	11 th February 2022

I am writing to let you know that an appeal has been made to the Planning Inspectorate in respect of the above site.

The appeal is against a refusal and is to be decided on the basis of the written representations procedure.

The Planning Inspectorate have introduced an online appeals service which you can use to comment on this appeal. You can find the service through the Appeals area of the Planning Portal – see <https://acp.planninginspectorate.gov.uk>. Alternatively, you can send your comments to West3@planninginspectorate.gov.uk or Planning Inspectorate, Room 3c, Temple Quay House, 2 The Square, Bristol BS1 6PN, quoting the Inspectorate reference. Comments should be received by **18th March 2022**.

The Inspectorate may publish details of your comments, on the internet (on the appeals area of the planning portal). Your comments may include your name, address, email address or phone number, please ensure that you only provide information, including personal information belonging to you that you are happy will be made available to others in this way. If you supply information belonging to a third party please ensure you have their permission to do so. More detailed information about data protection and privacy matters is available on the Planning Portal.

Any representations received after the deadline will not normally be seen by the Inspector and will be returned.

Any comments you may have already made following the original application will also be forwarded to the Inspectorate (unless they are expressly confidential) but you may withdraw, modify or amplify them now if you wish. All comments received will be copied to the appellant and will be taken into account by the Inspector in deciding the appeal.

If you wish to receive a copy of the appeal Decision Letter, you should write to the Planning Inspectorate specifically requesting one.

The Planning Inspectorate will not acknowledge your letter unless you specifically ask them to do so. They will, however, ensure that your letter is passed on to the Inspector dealing with the appeal.

Finally, you can get a copy of one of the Planning Inspectorate's "Guide to taking part in planning appeals" booklets free of charge from GOV.UK at <https://www.gov.uk/government/collections/taking-part-in-a-planning-listed-building-or-enforcement-appeal>.

When made, the decision will be published online at <https://acp.planninginspectorate.gov.uk>.

Yours faithfully,

Head of Development Management

Melksham CATG Expenditure and 2021/2022 Budget

Scheme	Resolution Date	Committee	Estimate	CATG Commitment	Expenditure	MTC Commitment	MTC Payment Made/ Outstanding
Melksham Bus Shelters Lowbourne & Church Lane	28/05/2019	Ec Dev and Planning	£11,150	0	£10,180.63	£10,181	£10,181
	07/10/2019	Asset Management			Confirmed 25.11.21		£10,181 - street furniture budget in Earmarked Reserves
Melksham Snarlton Lane/ Nightingale Close barrier, hatching and signpost	17/06/2019	Ec Dev and Planning					
Melksham Bath Road/ Union Street bollards, and resurfacing	29/07/2019	Ec Dev and Planning	£1,500 Ball park	£505	£1,010.11 Confirmed 25.11.21	£505	£505
Melksham Snarlton Lane - sign re no access to Snarlton Farm	29/07/2019	Ec Dev and Planning					Closed and completed per CATG 24.09.2020
Melksham Old Broughton Road - drop kerbs	21/10/2019	Ec Dev and Planning	£2,885.68	£1,442.84	£2,885.68	£1,442.64	£1,202.37
Weavers Croft and The City					Final		11/11/2021

Scheme	Resolution Date	Committee	Estimate	CATG Commitment	Expenditure	MTC Commitment	MTC Payment Made/ Outstanding
Melksham Sandridge/ Maple Close -footway CAT survey,land dedication for boundary fence.	03/12/2020	CATG	£450 Ball park	£450.00	£450.00	£0.00	£0
Substantial legal fees			£6,000 Ball park 25.11.21	£3,000	0	£3,000	£3,000
Melksham Snarlton Lane - access only road	09/03/2021	Ec Dev and Planning	n/k	n/k			
(Email to Peter Dunford 14/02/2022)							
Melksham Westbury View - white H line to be painted adjacent to dropped kerb No 34	04/05/2021	Ec Dev and Planning	n/k	n/k			
(Email to Peter Dunford 14/02/2022)							
Melksham Heather Ave, Dorset Crescent - two offset bollards	08/11/2021	Ec Dev and Planning	£1,000 Max	£500 Max per 25.11.2021			£500
Hazelwood Road and St Michael's Road - low level lighting	10/01/2022	Ec Dev and Planning	n/k	n/k			

Scheme	Resolution Date	Committee	Estimate	CATG Commitment	Expenditure	MTC Commitment	MTC Payment Made/ Outstanding
The Crays to Montague Place - dropped kerb	31/01/2022	Ec Dev and Planning	n/k	n/k			
Budget 2021/2022	£7,500						
Allocated:							
Old Broughton Road	-£1,202.37						
Maple Close/ Sandridge Road	-£3,000						
Union Street	-£505						
Balance	£2,793						

This page is intentionally left blank

Agenda Item 7.2

Highways Improvement Request Form

Contact Details

Name:	Mike Sankey	Date:	06/02/2022
Address:			
Telephone No:			
Email Address:			

Issue Details

Location of Issue:	Eastern way from junction with Snowberry lane to new T junction with Camomile place
Community Area:	Melksham
Parish or Town Council:	Melksham town
Nature of Issue:	
Speeding continues to be an issue in Snowberry Lane and beyond despite the welcome installation of SID by MTC. With the impending opening of Camomile place latter this year there is an opportunity to impose further measures to manage traffic volumes and speeds in this area.	
How long has it been an issue?	Some years but increasing
What would you like done to resolve this issue?	
Subject the length of road mentioned above to: A 30mph speed limit A 3T Mgvw restriction, (to also cover Snowberry lane to the Spa road roundabout). Both measures to be introduced upon the opening to through traffic of Camomile place.	
Have you been in touch with your local Wiltshire Councillor? (Yes/No)	Yes

***This form needs to be completed and e-mailed or sent to your local Town or Parish Council.
Town and Parish contact details are available via the link below:***

<https://cms.wiltshire.gov.uk/mgParishCouncilDetails.aspx>

Town or Parish Council Comments: (To be completed by Town or Parish Council only)

Agenda Item 7.3

Highways Improvement Request Form

Contact Details

Name:	Shaun Deneen	Date:	12 th December 2021
Address:	[Redacted Address]		
Telephone No:			
Email Address:			

Issue Details

Location of Issue:	Spa Road (Wharf Court entrance)
Community Area:	Melksham
Parish or Town Council:	Melksham
Nature of Issue:	
<p>I am writing to you on behalf of the residents of Wharf Court (Spa Road, Melksham) in relation to the dangerous situation we now believe requires attention. As you will know, there is a problem with speeding vehicles in Spa Road. I am aware that there is now a speed indicator on the "hump" in Spa Road to try and slow traffic down, however, many vehicles ignore this and both myself and other residents have seen the indicator registering speeds in excess of 40mph. This makes it hazardous to safely drive out of Wharf Court as visibility up Spa Road is limited by the "hump" in the road when driving out and turning left or right. There is also a risk to drivers coming down Spa Road (towards town) to Wharf Court, who come over the "hump" then have to slow to turn or sometimes wait for someone else to come out before driving into Wharf Court. They risk a rear shunt from drivers coming down the road as they are not visible until the last minute to speeding, or indeed other drivers.</p> <p>Is there any possibility that someone could arrange a site visit to come and assess the risks with a view to suggesting ways of reducing them before there is a serious accident or fatality? We have quite a busy car park due to relatives visiting, carers coming to look after residents, deliveries from supermarket vans etc. etc. so statistically, it is highly likely that there will be a serious incident before too long, especially as the road will only get busier as the town expands with more housing, cars etc. out by Bowerhill and the surrounding areas.</p>	
How long has it been an issue?	The situation has been a problem since before I moved here in 2013 but is getting worse due to the amount of traffic and speeding drivers, there have been several near misses.
What would you like done to resolve this issue?	
<p>I would like some sort of signage to indicate to drivers travelling towards the town along Spa Road that there is a concealed entrance on the left and also the installation of some way of letting drivers leaving Wharf Court know that a vehicle is approaching the "hump" and that they should wait or depart with caution.</p>	

Highways Improvement Request Form

Contact details

Name: Darren Anteney

Address: [REDACTED]

Date: 25/01/2022

Telephone No.: [REDACTED]

Email address: [REDACTED]

Issue Details

Location of Issue: Corner of Lapwing Road and Linnet Lane, Melksham

Community Area: Melksham

Parish or Town Council: Melksham Town Council

Nature of Issue: I am extremely concerned by one of the junctions on the road that I am currently living. The junction in question is where Lapwing Road, Melksham joins Linnet Lane, Melksham. I have two concerns which I have broken down into two sections. Concern 1 - road issues travelling along Linnet lane, turning left onto Lapwing road are cutting the corner by using the footpath. A large percentage of cars have at least two wheels on the pavement and I have seen occasions where cars have clipped the bushes on the garden on the corner. Along with road users inability to follow the 20mph speed limit means that any pedestrians on the corner or coming around the corner have a high probability of being struck and killed! This is the same as people joining Linnet Lane from Lapwing road are cutting the corner again across the pavement.

The route cause of the issue is that the road has been raised meaning that the road and the pavement are on the same level. There is no penalty for road users leaving the road area. Normally the raised pavement would provide some protection. I have highlighted these areas on the picture attachments. I would like Wiltshire council to install permanent metal bollards on the footpath as soon as possible to protect all pedestrians. I have witnessed several extremely close calls over the past few months and I am concerned that someone will be killed!

How long has it been an issue? Years

What would you like done to resolve this issue? Railings or metal bollards on the edge of the pavement. Like what has been setup in Goldfinch Road, Melksham

This form needs to be completed and e-mailed or sent to your local town or parish council (link provided below)

<https://cms.wiltshire.gov.uk/mgParishCouncilDetails.aspx>

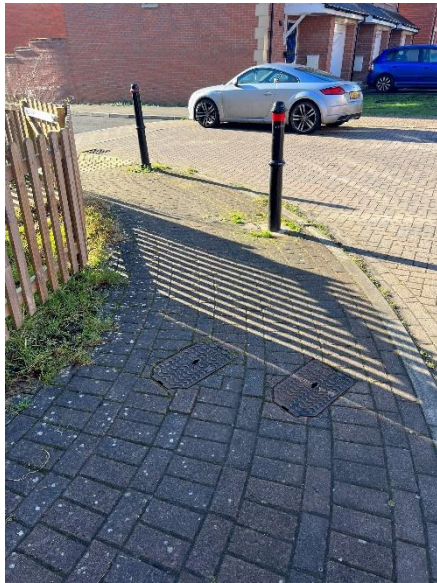

Agenda Item 7.5

Highways Improvement Request Form

Contact Details

Name:	Sue Mortimer	Date:	10 February 2022
Address:	[Redacted Address]		
Telephone No:			
Email Address:			

Issue Details

Location of Issue:	Church Street/High Street
Community Area:	Melksham
Parish or Town Council:	Melksham Town Council
Nature of Issue:	
<p>The sound alerts at the 3 pedestrian crossing points at the busy junction of Church Street and High Street Melksham are not working. Possibly might have been turned off when crossings were not in sync. It was been brought to my attention that not having the bleepers causes problems for visually impaired pedestrians. Other pedestrians have also commented on the lack of the bleeping signal.</p>	
How long has it been an issue?	Since the audio was switched off quite a few years ago.
What would you like done to resolve this issue? To restore the bleeping signal facility.	
Have you been in touch with your local Wiltshire Councillor? (Yes/No)	Yes

This form needs to be completed and e-mailed or sent to your local Town or Parish Council. Town and Parish contact details are available via the link below:

<https://cms.wiltshire.gov.uk/mgParishCouncilDetails.aspx>

Town or Parish Council Comments: (To be completed by Town or Parish Council only)

Agenda Item 7.6

Highways Improvement Request Form

Contact Details

Name:	Keith Morse	Date:	04/03/2020
Address:			
Telephone No:			
Email Address:			

Issue Details

Location of Issue:	Junction of Snarlton Lane with the A3102
Community Area:	Melksham
Parish or Town Council:	Town council.
Nature of Issue:	
Heavy goods vehicles entering Snarlton Lane looking to get to Snarlton Farm.	
How long has it been an issue?	Since the new road was put through cutting the lane off.
What would you like done to resolve this issue?	
Signs on the A3102 giving drivers clear directions to the farm via A3102 and then on to Eastern Way.	
Have you been in touch with your local Wiltshire Councillor? (Yes/No)	No

***This form needs to be completed and e-mailed or sent to your local Town or Parish Council.
Town and Parish contact details are available via the link below:***

<https://cms.wiltshire.gov.uk/mgParishCouncilDetails.aspx>

Town or Parish Council Comments: (To be completed by Town or Parish Council only)

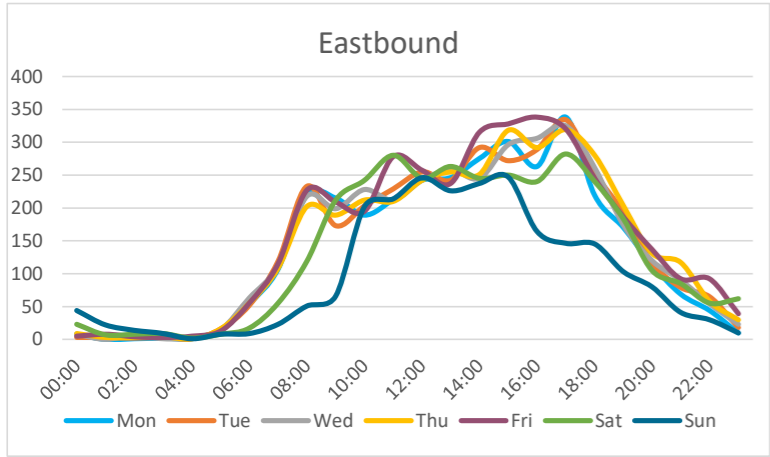

Direction	7-Day Average Speed	7-Day 85th %ile Speed	On a 7-day average		
Eastbound	26.2	29.9	14.3%	2.4%	0.1%
Westbound	26.0	29.3	11.5%	1.6%	0.1%
Combined	26.1	29.6	12.9%	2.0%	0.1%
	mph	mph	of vehicles are travelling over posted speed limit (PSL)	of vehicles are traveling 10% +2 over PSL (35mph)	of vehicles are 15mph over PSL (45mph)

30

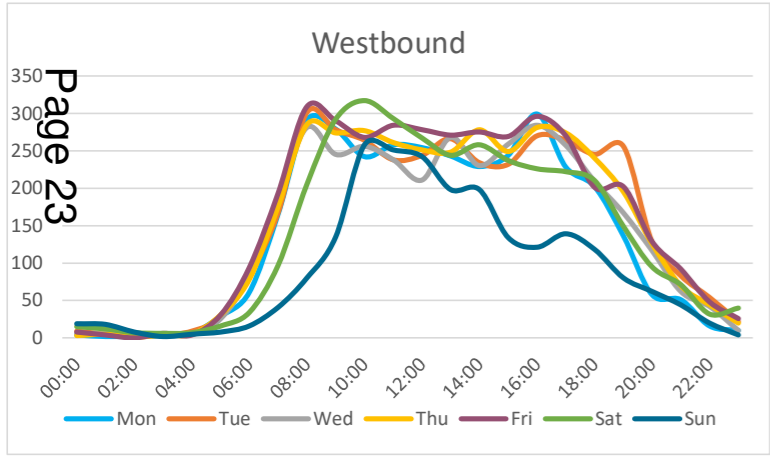
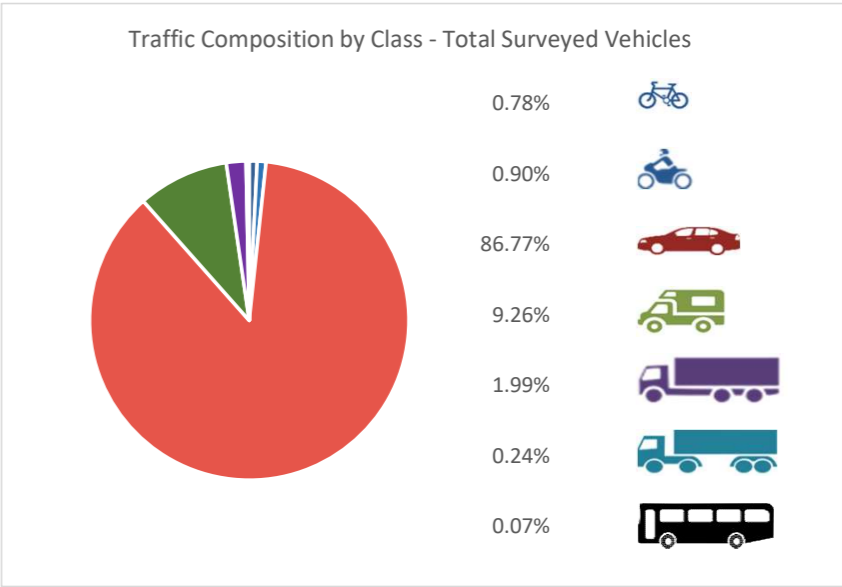

Direction	Weekday Average Total Traffic	7-Day Average Traffic	Weekly Traffic Total
Eastbound	3487	3287	23009
Westbound	3595	3361	23527
Combined	7082	6648	46536

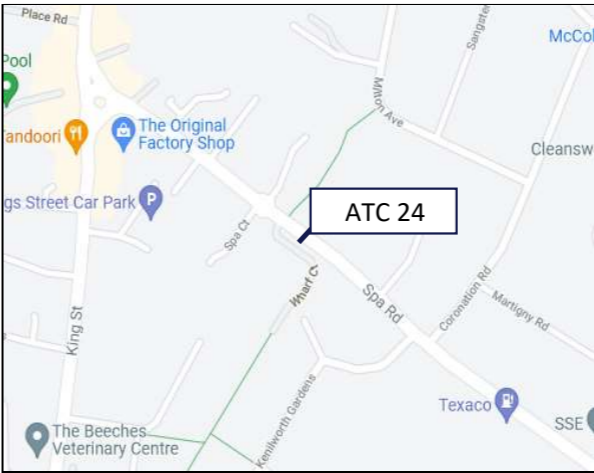

Incidents/Observations
No incidents or observations during the survey period

Data annotated with '*' denotes when a given time period has been affected by data loss. For a full breakdown of data loss please refer to Data Summary.

Tracsis will retain all personal data relating to this project, including all video images, for a period of 3 months after receipt of this report and all other data files for one year. If you would like a copy of the personal data or wish for us to retain for a longer period, please do not hesitate to contact us.

This page is intentionally left blank

WILTSHIRE COUNCIL

ROAD TRAFFIC REGULATION ACT 1984

1. PEDESTRIAN CROSSING – A350 WESTERN WAY, MELKSHAM AND
MELKSHAM WITHOUT
2. PEDESTRIAN CROSSING – SEMINGTON ROAD, MELKSHAM WITHOUT

NOTICE IS HEREBY GIVEN that Wiltshire Council in exercise of its powers under Section 23 of the Road Traffic Regulation Act 1984 proposes as follows:

No.1

To amend the controlled zone at the existing Toucan crossing and extend the existing zig zag markings in **A350 Western Way** as follows:

- a) Northern side of carriageway – centre of the crossing is at a point approximately 31 metres east of its roundabout junction with Semington Road. The controlled zone will be a distance of approximately 41 metres from the roundabout junction with Semington Road in an easterly direction;
- b) Southern side of carriageway - centre of the crossing is at a point approximately 35 metres east of its roundabout junction with Semington Road. The controlled zone will cover a distance of approximately 65 metres from the roundabout junction with Semington Road in an easterly direction.

No.2

To change the status of the existing Zebra Crossing in **Semington Road** to become a “Parallel Crossing” (a combined pedestrian and cycle crossing which has priority over the road which it crosses) as follows:

Centre of the crossing is at a point approximately 15 metres north of the access to Melksham Mobile Home Park (centre). The controlled zone will cover a distance of approximately 41 metres from the roundabout junction with the A350 in a southerly direction.

Documents will not be deposited for viewing at Council Offices. If you would like copies of documents or further information on the above proposal please email TrafficOrderConsultations@wiltshire.gov.uk. Full details can also be found by visiting <https://www.wiltshire.gov.uk/troconsultations.htm>

Comments on the proposal together with the reasons for which they are made should be sent by post to reach the Traffic Order Team, Sustainable Transport, County Hall, Bythesea Road, Trowbridge, BA14 8JN allowing 7 days, by email to TrafficOrderConsultations@wiltshire.gov.uk or using the response form on the website at <https://www.wiltshire.gov.uk/troconsultations.htm> to reach the Sustainable Transport Group by 21st March 2022 quoting reference LJB/TRO/MELW/HY296.

Sustainable Transport Group, County Hall, Bythesea Road TROWBRIDGE BA14 8JN

25th February 2022

This page is intentionally left blank

DO NOT SCALE

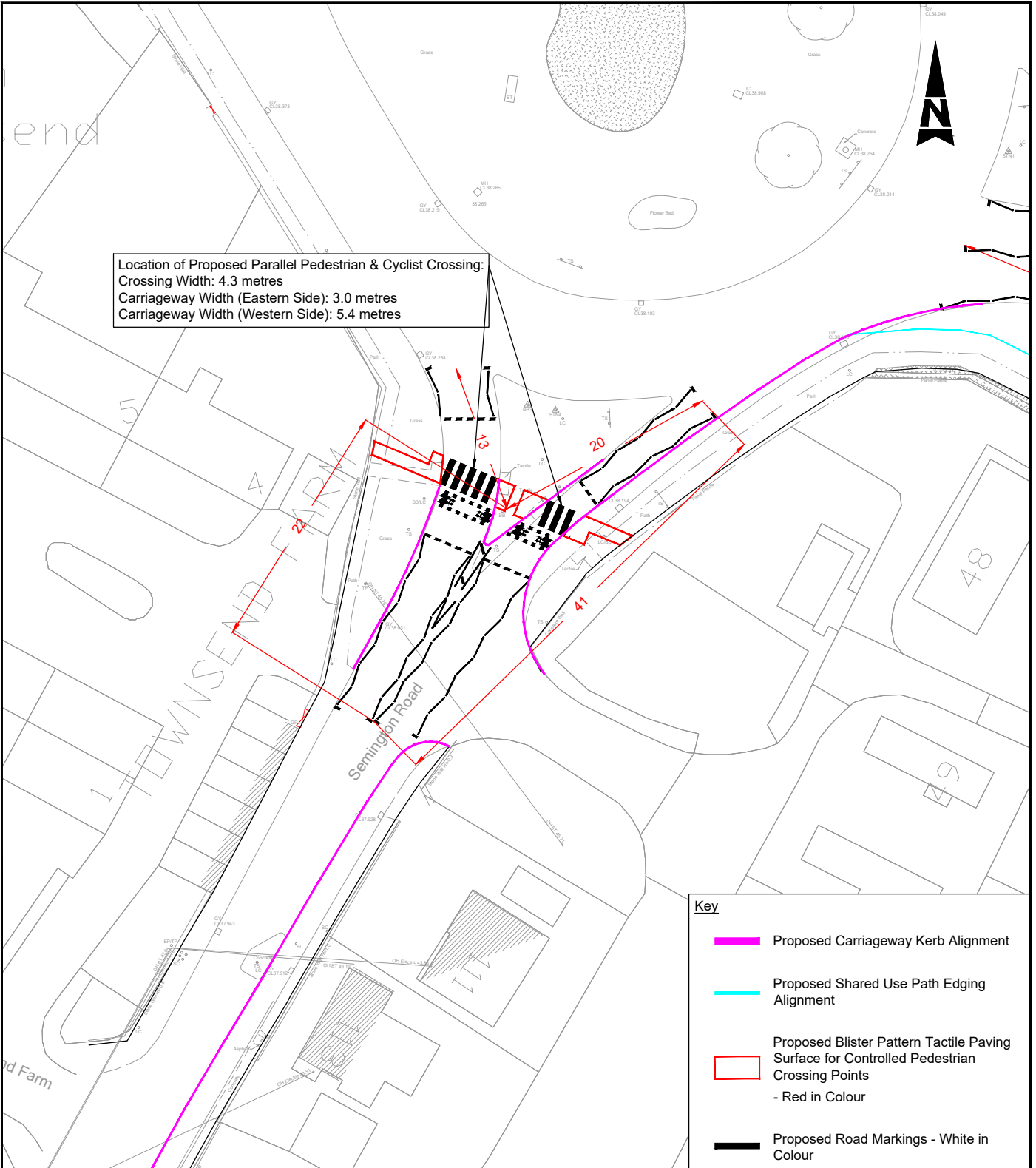

Postal Area: BA14 7QQ to SN12 6EW
USRN: 43801566, 43801718, 43802613, 43802848,
43801635, 43801636, 43802571, 43802894,
43801727, 43801732 & 43802839
OS Grid Ref: **TBC**
Phillips Street Atlas: Page 102 - A3 to Page 94 - A2
Road Speed Limit: 20mph, 30mph & 60mph

THIS MAP IS REPRODUCED FROM ORDNANCE SURVEY MATERIAL WITH THE PERMISSION OF ORDNANCE SURVEY ON BEHALF OF THE CONTROLLER OF HER MAJESTY'S STATIONERY OFFICE. © CROWN COPYRIGHT. UNAUTHORISED REPRODUCTION INFRINGES CROWN COPYRIGHT AND MAY LEAD TO PROSECUTION OR CIVIL PROCEEDINGS. 100049050, 2020

Notes

- Limits of work and dimensions are approximate and are to be agreed on site with the Engineer or Site Representative.
- Do not scale from this drawing.
- All dimensions are in metres unless stated otherwise.

Key

- Proposed Carriageway Kerb Alignment
- Proposed Shared Use Path Edging Alignment
- Proposed Blister Pattern Tactile Paving Surface for Controlled Pedestrian Crossing Points
- Red in Colour
- Proposed Road Markings - White in Colour

SAFETY, HEALTH AND ENVIRONMENTAL INFORMATION

IN ADDITION TO THE HAZARDS/RISKS NORMALLY ASSOCIATED WITH THE TYPES OF WORK DETAILED ON THIS DRAWING, NOTE THE FOLLOWING SIGNIFICANT RESIDUAL RISKS				
CONSTRUCTION	NONE			
MAINTENANCE/CLEANING	NONE			
USE	NONE			
DECOMMISSIONING/DEMOLITION	NONE			
C1	First Issue	LSH	26/01/22	RV KNB
Rev	Description	By	Date	Chk'd Auth

ATKINS
Member of the SNC-Lavalin Group

Atkins Limited
Consulting Engineers,
County Gate, County Way
Trowbridge, Wiltshire
BA14 7FJ
Tel: 01225 730360
www.atkinsglobal.com

Client
Wiltshire Council

Project
A361 Hilberton to Melksham Cycle Scheme
Tranche 2 - Emergency Active Travel Fund (EATF)

Title TRO Legal Advert - Parallel Zebra Crossing				
Sheet Size	Original Scale	Designed/Drawn	Checked	Authorised
A4	1 : 500	LSH	RV	KNB
Status	Drawing Number	Date	Date	Date
S2	-	26/01/22	26/01/22	26/01/22
				Rev
				C1

This page is intentionally left blank

DO NOT SCALE

A4

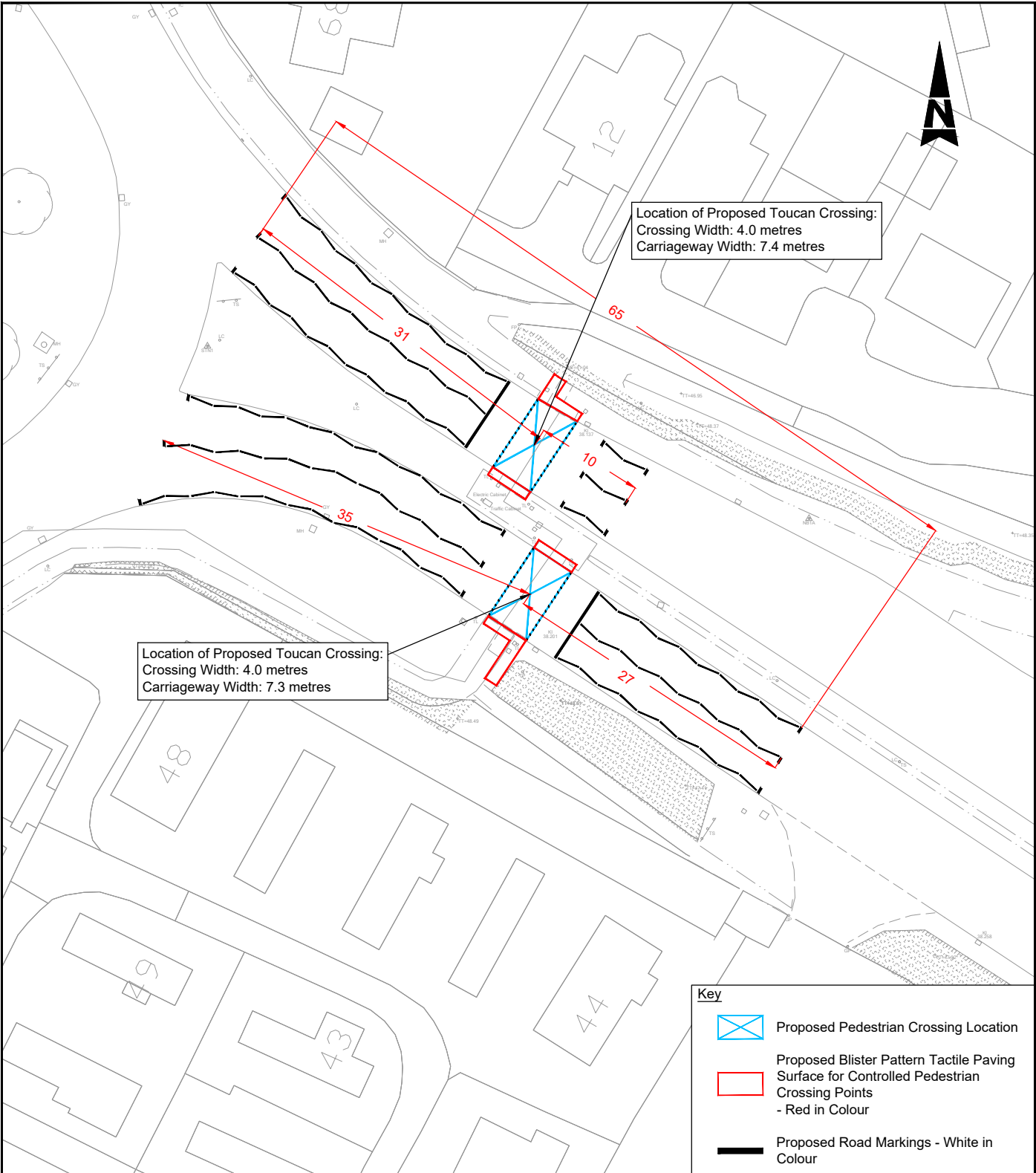

Postal Area: BA14 7QQ to SN12 6EW
USRN: 43801566, 43801718, 43802613, 43802848,
43801635, 43801636, 43802571, 43802894,
43801727, 43801732 & 43802839
OS Grid Ref: **TBC**
Philips Street Atlas: Page 102 - A3 to Page 94 - A2
Road Speed Limit: 20mph, 30mph & 60mph

THIS MAP IS REPRODUCED FROM ORDNANCE SURVEY MATERIAL WITH THE PERMISSION OF ORDNANCE SURVEY ON BEHALF OF THE CONTROLLER OF HER MAJESTY'S STATIONERY OFFICE. © CROWN COPYRIGHT. UNAUTHORISED REPRODUCTION INFRINGES CROWN COPYRIGHT AND MAY LEAD TO PROSECUTION OR CIVIL PROCEEDINGS. 100049050, 2020

- Notes**
- Limits of work and dimensions are approximate and are to be agreed on site with the Engineer or Site Representative.
 - Do not scale from this drawing.
 - All dimensions are in metres unless stated otherwise.

Key	
	Proposed Pedestrian Crossing Location
	Proposed Blister Pattern Tactile Paving Surface for Controlled Pedestrian Crossing Points - Red in Colour
	Proposed Road Markings - White in Colour

SAFETY, HEALTH AND ENVIRONMENTAL INFORMATION				
IN ADDITION TO THE HAZARDS/RISKS NORMALLY ASSOCIATED WITH THE TYPES OF WORK DETAILED ON THIS DRAWING, NOTE THE FOLLOWING SIGNIFICANT RESIDUAL RISKS				
CONSTRUCTION	NONE			
MAINTENANCE/CLEANING	NONE			
USE	NONE			
DECOMMISSIONING/DEMOLITION	NONE			
C1	First Issue	LSH	26/01/22	RV KNB
Rev	Description	By	Date	Chk'd Auth

Atkins Limited
Member of the SNC-Lavalin Group
Consulting Engineers,
County Gate, County Way
Trowbridge, Wiltshire
BA14 7FJ
Tel: 01225 730360
www.atkinsglobal.com

Wiltshire Council

Client

Project

A361 Hilberton to Melksham Cycle Scheme
Tranche 2 - Emergency Active Travel Fund (EATF)

TRO Legal Advert				
Sheet Size	Original Scale	Designed/Drawn	Checked	Authorised
A4	1 : 500	LSH	RV	KNB
Date	Date	Date	Date	Date
26/01/22	26/01/22	26/01/22	26/01/22	26/01/22
Status	Drawing Number			Rev
S2	-			C1

This page is intentionally left blank

WILTSHIRE COUNCIL

ROAD TRAFFIC REGULATION ACT 1984

1. **PEDESTRIAN CROSSING – A350 WESTERN WAY, MELKSHAM AND
MELKSHAM WITHOUT**
2. **PEDESTRIAN CROSSING – SEMINGTON ROAD, MELKSHAM WITHOUT**

Statement of Wiltshire Council's reasons for proposing
to make the above

The amendments to these crossings are proposed to provide safe and improved crossing locations for pedestrians and cyclists. This forms part of the proposal for the provision of a cycle route between Hilperton and Melksham being delivered as part of the DfT Emergency Active Travel Fund.

This page is intentionally left blank



Agenda Item 9

Melksham Town Council

Town Hall, Melksham, Wiltshire, SN12 6ES
Tel: (01225) 704187

Town Clerk and RFO Linda Roberts BA(Hons) PGCAP, FHEA, FLSCC

Councillor Dr Mark McClelland
Wiltshire Council
Cabinet Office
County Hall
Bythesea Road
Trowbridge
BA14 8JN

18 January 2022

Dear Councillor McClelland

Electric Vehicle Charging points in Melksham

At a recent Economic Development and Planning Committee meeting members were keen to establish when the electric charging points would be reinstated in King Street carpark. I was therefore requested to write to you to establish the following:

Has the tender process started?

What date is a tender decision due?

When is work anticipated to start?

What is the specification for the charging units in the tender documents? For example, what will the KW be and how many units will be installed?

With regard to the EV charging points to be installed at the Campus site; would you be able to confirm the specification and when will they be available for public use.

The urgency is that currently there are no electric charging points in the town. The Melksham Community Area Neighbourhood Plan, made in July 2021, has a policy promoting and supporting EV charging points. The Town Council would very much like to see Melksham become an electric car friendly town.

Yours sincerely

Mrs L A Roberts
Town Clerk

Email: townhall@melkshamtown.gov.uk Web: www.melkshamtown.gov.uk Facebook: facebook.com/melksham.town



Melksham Town Council

Town Hall, Melksham, Wiltshire, SN12 6ES

Tel: (01225) 704187

Town Clerk and RFO Linda Roberts BA(Hons) PGCAP, FHEA, FLSCC

25th January 2022

Mrs L.A. Roberts
Town Clerk
By E-mail: linda.roberts@melksham-tc.gov.uk

Cabinet Office
County Hall
Bythesea Road
Trowbridge
Wiltshire
BA14 8JN

Our Ref: MM/LY/22054

Dear Mrs Roberts

Thank you for your letter regarding Electric Vehicle Charging Points (EVCPs) in Melksham.

I note your questions concerning Wiltshire Council's plans for vehicle charging and I trust you have seen the new Wiltshire Council Electric Vehicle Charging Strategy for 2021 to 2024. The Strategy details the council's arrangements and the future provision. The council's Strategy is guided by government guidance to ensure that a joined-up approach is undertaken across the country.

The government's outcomes with regard to funding for electric vehicle charging hits three of the four segments of the EV charging infrastructure market: Home Charging, Workplace Charging and Rapid Charging (on trunk roads). However, it recognises that the fourth sector, Destination Charging, is most suited to private sector investment.

The council's Melksham provision is what is known as a Destination Charging point. Historically the Electric Vehicle Charging Infrastructure on Wiltshire Council land was provided by a commercial provider BP Pulse, with their customers paying for the maintenance. However, BP Pulse are unable to undertake the replacement of the existing machines without a long-term commitment by Wiltshire Council for the provision. Due to the value of this request the council must follow a robust procurement exercise.

Wiltshire Council recognises that currently the private sector is still emerging so in the short term it has committed to the provision of a number of Destination Charging points, including the replacement of the unit in Melksham.

I note the Town council is keen to see more EVCPs supplied, and we would be delighted to support Melksham Town Council identify opportunities for additional machines. A number of town councils are undertaking trials in the surrounding areas and we would be pleased to advise you of the lessons learnt. We can also signpost you to grants to aid in the provision.

Wiltshire Council is also pleased to enter into agreements with the Town Council for the provision of chargers on our land.

With regard to your questions regarding where Wiltshire Council is in its process for the replacement of the Kings Street charger. The council has tendered a survey of its workplaces to identify the infrastructure requirements for EVCPs. This survey is underway and will be completed by the end of March. At which time the machine provision can be tendered. The decision to replace the EVCP in Melksham has already been approved. It is hoped the new charger will be in place by the autumn but will be subject to the normal procurement process timetable. Currently the plan is to install a like for like provision with a 44kwh charger. However, this could be subject to change.

For the Melksham Campus I understand the current proposal is to provide 3 number 7 kwh EVCPs which service 6 vehicles. I am advised that this is the maximum number due to the external power supply infrastructure. These will be open to public use once operational.

I trust this answers all your questions.

Yours sincerely



Cllr Dr Mark McClelland
Cabinet Member - Transport, Waste, Street Scene & Flooding

Direct line: 01225 718386

Email: mark.mcclelland@wiltshire.gov.uk

Received From Wiltshire Council Community Campus and Hub Support Officer

Received 14/02/2022 via email

I am writing to you as part of the pre-consultation process for the introduction of an Off Street Parking Order at Melksham Campus. Following the feedback on our previous consultation at the end of January 2022 on the proposed restrictions, an amendment has been made to our proposal for the Off-Street Parking Order for the site.

It is a pre-occupation Planning condition for the development of the Campus that the facility cannot be brought into use until a car parking management plan has been submitted to Planning and implemented in full in accordance with the approved details. The restriction order will ensure there is reasonable availability of parking for users of the campus.

It is proposed that the area outlined in yellow on the attached site plan will be covered by an Off-Street Parking Order. This has not changed from the first consultation.

Proposal

It is proposed that parking at the Community Campus is pay and display in line with the other car parks. This will align the Community Campus Car Park with other long stay car parks in Melksham and with Wiltshire Council's overall policy that car parking is chargeable. All Wiltshire Council managed public car parks in Melksham are chargeable. The current parking charges, days and times are as follows:

Open	24 hours
Charges apply	Monday - Saturday 8am - 6pm excluding bank holidays
Current charges	Up to 1 hour: £0:30 Up to 2 hours: £1.10 Up to 3 hours: £2.00 Up to 4 hours: £2.70 Up to 5 hours: £3.60 All day £5.00
Blue badge	Free
Maximum stay	All day - No return in 3 hours
Blue badge	All day
Pay & display	3 machines (one in each area of the car park) Wiltshire Council MiPermit Portal Coin - no charge given Chip and pin and contactless

The parking meters will operate the MiPermit system in line with the other car parks in Melksham. This allows the issue of virtual permits for staff, on site clubs and partner organisations (number of permits to be negotiated with each organisation).

The hours that the order covers are proposed to be 8am – 6pm to align with other car parks in Melksham. The opening hours of the campus will be between 6am and 10pm Monday to Saturday and 7am and 10pm on Sundays and an Off-Street Parking Order will be placed on the car park to facilitate enforcement. Given the proximity of the campus to the town centre it is proposed that the patrolled hours are 8am to 6pm Monday to Saturday with free parking on Sundays and bank holidays. Enforcement Officers operate seven days a week and the number of patrols per day can be varied depending on perceived need.

Additional information:

- Customers will pay for a ticket displaying the time of arrival, from a parking machine which they will display in their vehicle
- There will be one solar powered parking machine in each of the three car park areas
- Parking restriction signage will be placed in each car park
- There are 201 spaces overall which includes 17 accessible, 12 family and six electric vehicle (also accessible) bays
- The car parks will be regularly patrolled by Parking Enforcement Officers
- Vehicles must be parked within a marked bay.
- A formal consultation process on these restrictions will take place in the coming weeks.

Points for consideration:

- Due to the proximity of the Campus car park to the town centre, not charging for parking is more likely to lead to insufficient spaces for users of the facility. It has been considered that non-campus users are more likely to park in the free spaces when they would normally use the other pay and display car parks
- This approach provides long stay parking provision for variable lengths of stay, rather than restricting the length of stay
- Users of both the Library and Melksham Blue Pool currently pay for parking in the public car parks and therefore this proposal does not present a change
- The above-mentioned charges are the current rates. It should be noted that charges are currently under review.

This revised proposal brings all public car parks in line with the Council's charging policy for public car parks, ensures that spaces are prioritised for users of the campus facilities and maintains the ability for staff, on sites clubs and lease organisations to be issued with virtual permits via MiPermit.

If you have any comments on the revised proposal, please could you respond to me close of play on **Monday 21 February**.

Site Layout

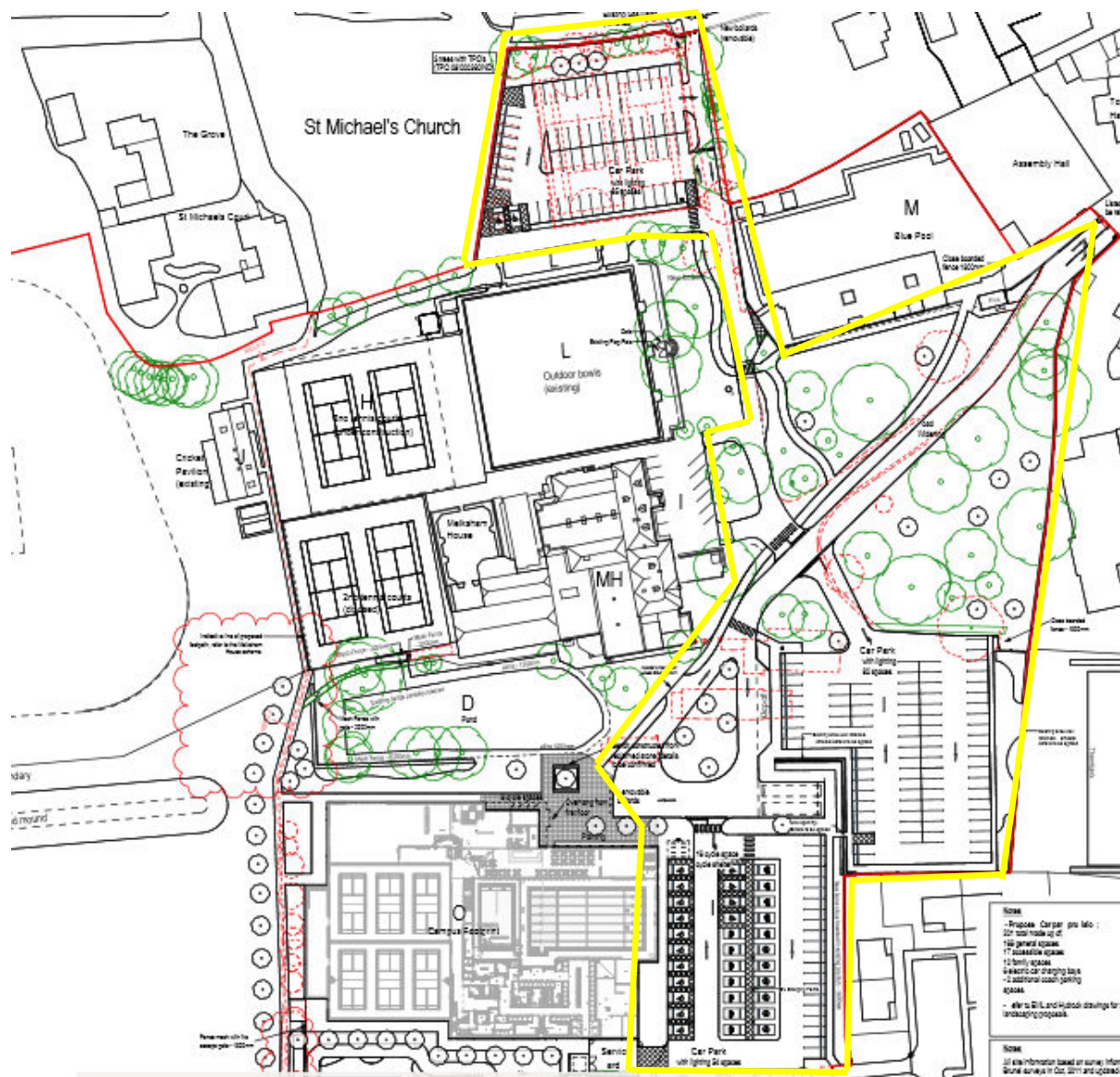

This page is intentionally left blank